

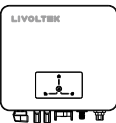





Quick Installation Guide

GT1 Series 1.6KW-6.0KW

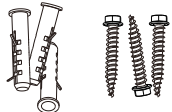
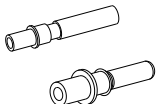
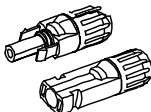
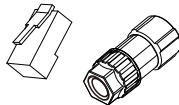
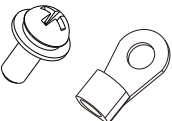
II

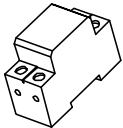
Packing Lists

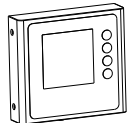
 Inverter * 1	 Bracket* 1	 Expansion Screws*3	 PV pin angle (positive*1/2 , negative*1/2)
 PV terminal (positive*1/2 , negative*1/2)	 RJ45 terminal*1/2 Grid terminal*1	 M5 Screws*1 Earth Screw*1	 Certificate card*1
 User manual*1 Quick installation guide*1	 Meter *1 (optional)	 Wi-Fi *1	 AC1-LCD*1(optional)

I

Preparation Tools

 Bit Φ10 Hammer drill	 Rubber hammer	 Tape ruler	 Spirit level\Marker
 Protective glasses	 Dustproof Cover	 OT terminals press clamp	 Wire stripper
 DC Voltage (Range ≥1100V DC) Multimeter	 Euro terminal crimping tool	 Diagonal pliers	 Multifunction terminal crimping tool (RJ45)

III

Inverter Installation

Step 1: Drill holes on the wall

- Locate the appropriate drilling holes and mark it with a marker pen.
- Drill holes with drill, make sure the holes are deep enough (at least 50mm) to support the inverter.

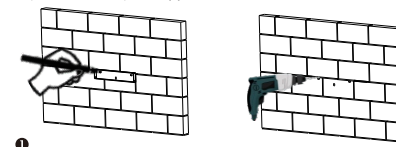

Step 2: Install the inverter to the wall

- Insert the expansion tubes into the holes and hang the back plate. Then tighten the screws to install it.

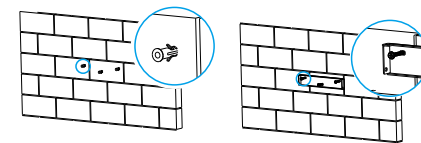

Step 3: Installation Self-check

- Hang the inverter on the back panel and lock the side with screws. (torque: 1.5N · m)

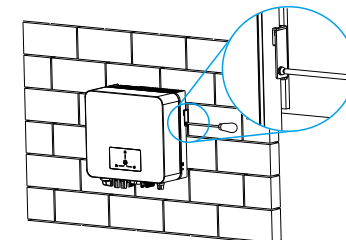
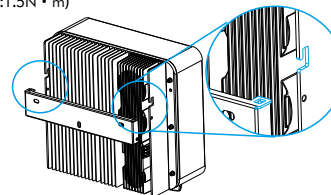

IV

PV Connection

- Wire diameter:12AWG;
- Stripping:5~7mm ;

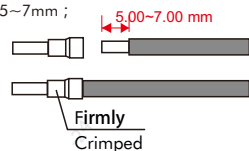

- Use crimping pliers to crimp it
- Pass through PV terminal

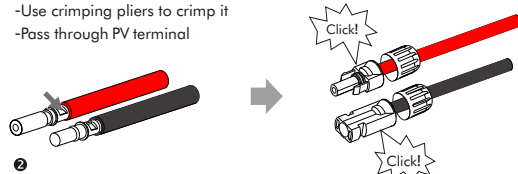

- Tighten the PV terminals
- Plug into inverter PV port

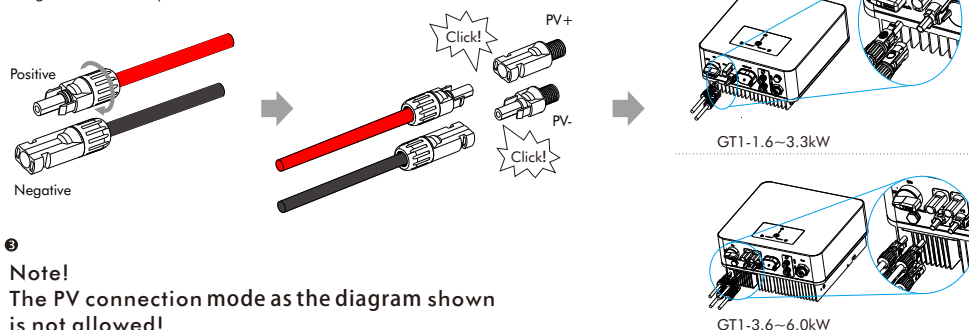

Note!

The PV connection mode as the diagram shown is not allowed!

VI

Ground/Communication Connection

- Prepare a 12AWG wire, strip it 5.00-7.00mm ;
- Then insert it through earth terminal and use a crimping tool to press it tightly ; (torque:1.5±0.2N · m)

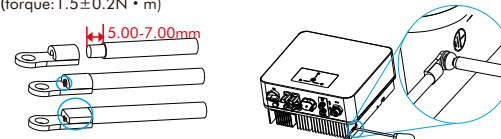

- Unscrew the screw and take off the cover, you see that are two RJ45 ports.
- Pass the wire harness through the cover with the waterproof plug, and then strip the wire. Stripping requirements: 5.00-7.00mm.



- Prepare the connector and the communication cable, following the PIN denition and assembly order below, then insert the cable into the corresponding RS485 port of the inverter, and tighten the waterproof connector.



PIN	1	2	3	4	5	6	7	8
DRM	DRM1/5	DRM2/6	DRM3/7	DRM4/8	3.3V	DRM0	3.3V	GND
Meter	X	485A2	X	X	X	X	485B2	X
AC-LCD	GND	X	X	485B1	485A1	X	X	12V

- Correspondingly insert the DRM\ LCD\ Meter port, and lock the cover. (torque:1.2±0.1N · m)

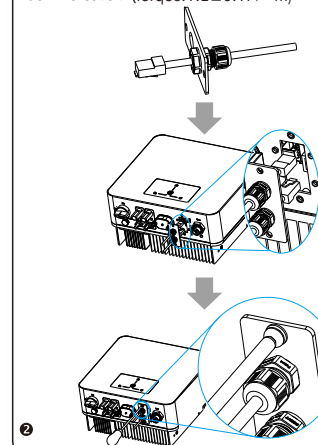

- After checking all connections are correct, turn on the external DC /AC breakers.
- Turn on the DC switch to the "ON" position.
- Inverter will start automatically when PV panels generate enough energy. The LED is solid green.

V

Grid Connection

- Cable diameter: GT1(1.6~3.3kW):10AWG, GT1(1.6~6.0kW):12AWG;
- Stripping:5~7mm ;



- Slide the cable nut and back shell onto the cable.

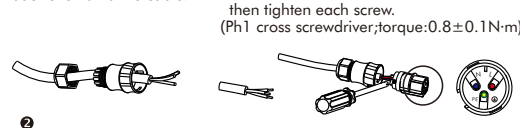

- Tighten the threaded sleeve .

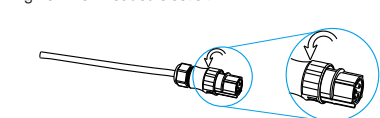

- Screw down the pressure screw. (Torque:3.0±0.3N · m)

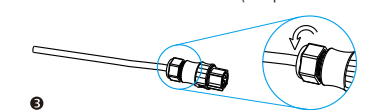

- Connect the Grid plug to the inverter, and tighten it.

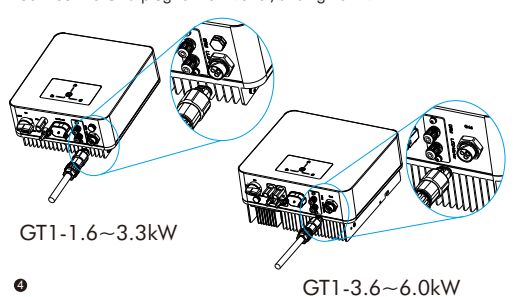

VII

Wi-Fi/Bluetooth Connection

- You can use the following communication modes to implement communication: Bluetooth and Wi-Fi. The Wi-Fi with built-in Bluetooth module for local monitoring and managing. all of which are described as follows:

Monitoring module connection diagram:

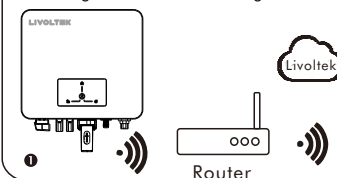

- Disassemble Livoltek's Wi-Fi accessories, and open the waterproof plug of the Wi-Fi port on the inverter;
- Install the Wi-Fi module at the corresponding position in the inverter, and buckle tightly, you mainly need to hear a "click";

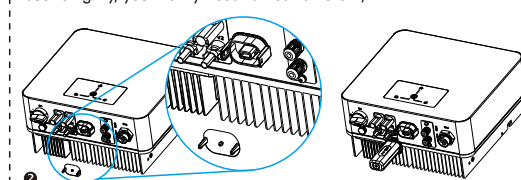

- You can turn on the Bluetooth function of the mobile phone, and view & set data of the inverter through inverter APP.

Check www.livoltek-portal.com for details operation and APP User Manual, APP User Manual is available for free from website.



Please go to the Livoltek APP or the external LCD screen to connect to the Internet and set it up. For specific details, please refer to the WiFi user manual.

- Open Livoltek APP, and select local mode;
- Find the inverter model and click connect (inverter Bluetooth is composed of the series and the last six digits of SN);
- Click "Settings" to enter "Basic settings" you can set the date time, language, and view view the inverter model, inverter version and inverter serial number.

